

BELGE SAHİBİ KURULUŞUN ADI NAME OF THE LICENCE HOLDER	PİMTAŞ PLASTİK İNŞAAT MAZLEMELERİ SANAYİ VE TİCARET ANONİM ŞİRKETİ
BELGE SAHİBİ KURULUŞUN ADRESİ ADDRESS OF THE LICENCE HOLDER	İNÖNÜ MAH.BALÇIK KÖYÜ YOLU ÜZERİ GEBZE PLASTİKÇİLER ORGANİZE SANAYİ BÖLGESİ İÇİ CUMHURİYET CAD. NO:52 41400 GEBZE KOCAELİ / TÜRKİYE

ÜRÜN ADI / PRODUCT

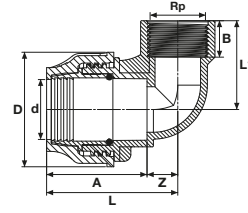

Kaplin Dişi Dirsek Female Elbow

Çap Dia	Kod Code	D (mm)	A (mm)	Z (mm)	L (mm)	B (mm)	L1 (mm)	Basınç PN	Koli/Ad. Box/Pcs
20x1/2"	EX70002400	44	48,5	11	59,5	14	25	16	550
20x3/4"	EX70002401	44	48,5	11	59,5	15	26	16	450
25x1/2"	EX70002402	50	53	13,5	66,5	14	27,5	16	360
25x3/4"	EX70002403	50	53	13,5	66,5	15	28,5	16	330
25x1"	EX70002404	50	53	13,5	66,5	17	30,5	16	270
32x3/4"	EX70002405	61	57	17	74	15	32	16	220
32x1"	EX70002406	61	57	17	74	17	34	16	180
32x1 1/4"	EX70002407	61	57	17	74	20	37	16	120
40x1"	EX70002408	74,5	73,5	21	94,5	17	38	16	120
40x1 1/4"	EX70002409	74,5	73,5	21	94,5	20	41	16	100
40x1 1/2"	EX70002410	74,5	73,5	21	94,5	20	41	16	90
50x1 1/4"	EX70002411	88	84,5	26	110,5	20	46	16	72
50x1 1/2"	EX70002412	88	84,5	26	110,5	20	46	16	60
63x1 1/2"	EX70002413	101	92,5	32,5	125	20	52,5	16	40
63x2"	EX70002414	101	92,5	32,5	125	24	56,5	16	40
75x2"	EX70002415	124	127	38,5	165,5	24	62,5	16	24
75x2 1/2"	EX70002416	124	127	38,5	165,5	28	66,5	16	20
90x2 1/2"	EX70002417	149	159	46	205	28	74	16	14
90x3"	EX70002418	149	159	46	205	30	76	16	13
110x3"	EX70002419	185	185	56	241	30	86	16	8
110x4"	EX70002420	185	185	56	241	36	92	16	8

