

|  |   |
|--|---|
| <b>BELGE SAHİBİ KURULUŞUN ADI</b><br>NAME OF THE LICENCE HOLDER      | PİMTAŞ PLASTİK İNŞAAT MAZLEMELERİ SANAYİ VE TİCARET ANONİM ŞİRKETİ  |
| <b>BELGE SAHİBİ KURULUŞUN ADRESİ</b><br>ADRESS OF THE LICENCE HOLDER | İNÖNÜ MAH.BALÇIK KÖYÜ YOLU ÜZERİ GEBZE PLASTİKÇİLER ORGANİZE SANAYİ BÖLGESİ İÇİ CUMHURİYET CAD. NO:52 41400<br>GEBZE KOCAELİ / TÜRKİYE  |
| <b>İLGİLİ TÜRK STANDARDI</b><br>RELATED TURKISH STANDARD             | TS EN ISO 1452-3 / Plastics piping systems for water supply and for buried and above-ground drainage and sewerage under pressure - Unplasticized poly (vinyl chloride) (PVC-U) - Part 3 : Fittings / 13.12.2011 |

**ÜRÜN ADI / PRODUCT**

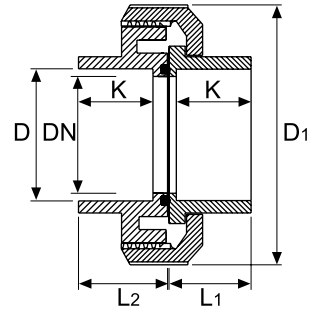

**UH-PVC Rakor**  
UH-PVC Union

| Çap<br>Dia | DN<br>(mm) | D1<br>(mm) | L1<br>(mm) | L2<br>(mm) | K<br>(mm) | Kg /Adet<br>Kg/Pcs | Koli/Ad.<br>Box/Pcs | Basınç<br>PN | Su için / For Water                | Asit için / For Acid               |
|------------|------------|------------|------------|------------|-----------|--------------------|---------------------|--------------|------------------------------------|------------------------------------|
|            |            |            |            |            |           |                    |                     |              | EPDM Conta Kod<br>EPDM O-Ring Code | EPDM Conta Kod<br>EPDM O-Ring Code |
| 16         | 12         | 53         | 19         | 24         | 16        | 0,05               | 125                 | 16           | 227 00 016 2                       | 227 55 016 2                       |
| 20         | 15         | 54         | 19         | 24         | 16        | 0,05               | 125                 | 16           | 227 00 020 2                       | 227 55 020 2                       |
| 25         | 20         | 62         | 22         | 27         | 19        | 0,07               | 100                 | 16           | 227 00 025 2                       | 227 55 025 2                       |
| 32         | 25         | 65         | 25         | 30         | 22        | 0,09               | 50                  | 16           | 227 00 032 2                       | 227 55 032 2                       |
| 40         | 32         | 83         | 28         | 36         | 26        | 0,16               | 30                  | 16           | 227 00 040 2                       | 227 55 040 2                       |
| 50         | 40         | 93         | 38         | 42         | 36        | 0,189              | 45                  | 16           | 227 00 050 2                       | 227 55 050 2                       |
| 63         | 50         | 116        | 41         | 52         | 43        | 0,35               | 25                  | 16           | 227 00 063 2                       | 227 55 063 2                       |
| 75         | 65         | 129        | 47         | 54         | 44        | 0,585              | 18                  | 16           | 227 00 075 2                       | 227 55 075 2                       |
| 90         | 80         | 155        | 56         | 61         | 51        | 0,98               | 10                  | 16           | 227 00 090 2                       | 227 55 090 2                       |
| 110        | 100        | 178        | 66         | 71         | 61        | 1,47               | 7                   | 16           | 227 00 110 2                       | 227 55 110 2                       |